



# TILING

## SIKA TILE INSTALLATION SYSTEMS

**BUILDING TRUST**







## EUROPE'S BEST NOW HERE IN NZ

- Technokolla, one of Europe's largest and most innovative tiling companies, is now a Sika company.
- Vast global expertise and technological innovation now available in NZ
- Complete tiling systems for every possible tiling location
- Systems for both new and refurbishment works
- Tailored CAD details for your job
- BRANZ approved waterproofing systems (811 & 812)
- Premium European quality for a very competitive price
- Eliminate the risk. Get it right first time with Sika Tile Installation Systems

## CONTENT

|           |   |
|-----------|---|
| <b>04</b> | Wet Areas: Drywall or Concrete              |
| <b>06</b> | Facades                                     |
| <b>08</b> | Large Format Tiles                          |
| <b>10</b> | Porcelain Tiles                             |
| <b>12</b> | Swimming Pool Tiling                        |
| <b>14</b> | New Balcony Tiling                          |
| <b>16</b> | Existing Tiled Balconies                    |
| <b>18</b> | Marble, Granite & Natural Stone Tiling      |
| <b>20</b> | Standards for Tile Adhesives & Grouts       |
| <b>22</b> | BRANZ Appraised for Waterproofing (811/812) |





# WET AREAS: DRYWALL OR CONCRETE

For wet areas such as bathrooms and kitchens, Sika has a complete installation system for your tiling: Firstly the waterproofing layer with a special one-component, fibre-reinforced, elastic cementitious mortar; then a polymer-modified, highly flexible cementitious tile adhesive. For the grouting there is the option of an aesthetically pleasing, coloured two-component epoxy resin based tile grout, which is also watertight and has high chemical and abrasion resistance. Alternatively, the flexible cementitious tile grout with a low modulus, high abrasion resistant and high water resistance. It is available in wide range of very stable colours, is easy to apply and easy to clean, plus it helps to prevent the proliferation of bacteria, fungi and mould. The installation system is completed with high performance, anti-fungal, elastomeric sealing tape and silicone joint sealant.

## SIKA TILING SYSTEM FOR WET AREAS

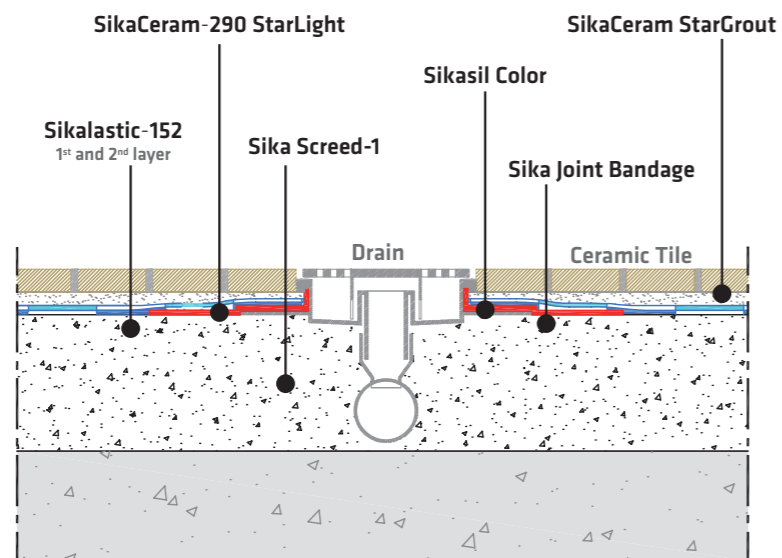

The illustration shows masonry walls. The Sika system is approved for all New Zealand wall substrates too.

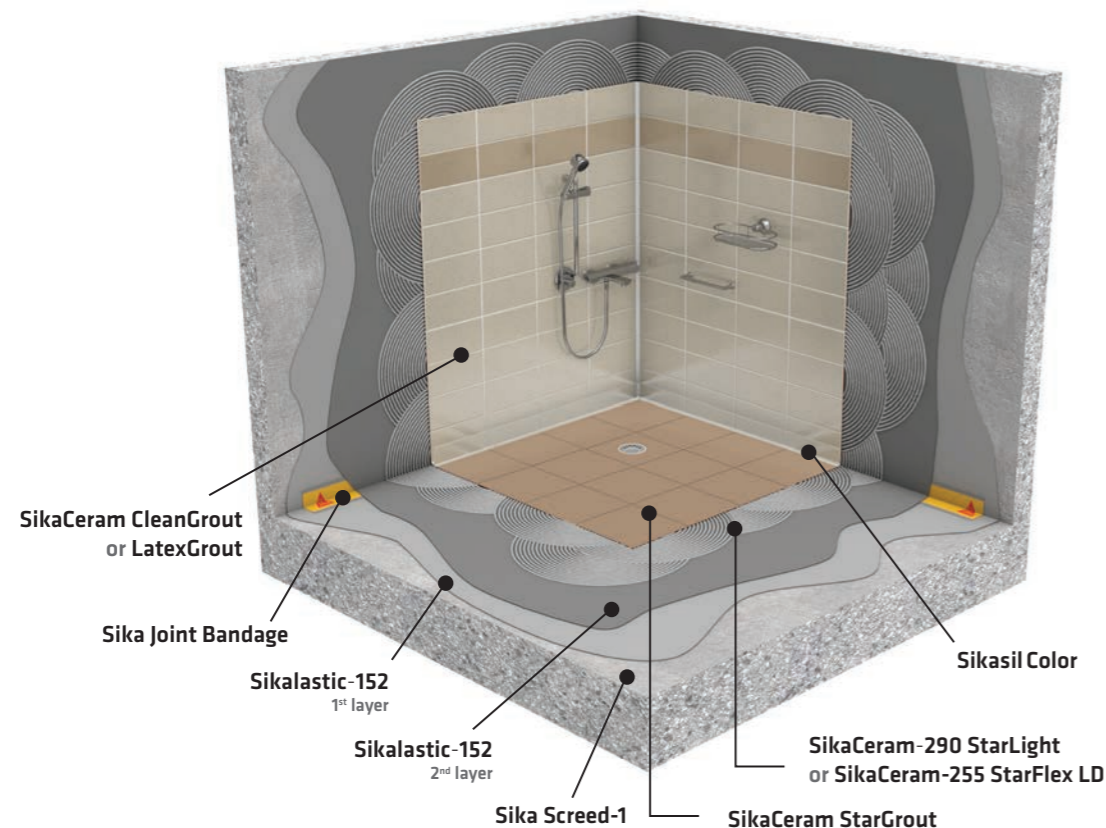

| TILING SYSTEM OPTION 1   | TILING SYSTEM OPTION 2   |
|--|--|
| <b>SURFACE TREATMENT</b> <ul style="list-style-type: none"> <li>■ <b>Sika Screed-1</b><br/>Pre-mixed fast setting, shrinkage-free screed for external and internal applications.</li> </ul>  | <b>SURFACE TREATMENT</b> <ul style="list-style-type: none"> <li>■ <b>Sika Screed-1</b><br/>Pre-mixed fast setting, shrinkage-free screed for external and internal applications.</li> </ul>  |
| <b>PRIMERS</b> <ul style="list-style-type: none"> <li>■ <b>Sika Primer-11 W</b><br/>Synthetic resin based primer for preparing gypsum or cementitious surfaces</li> </ul> Or: <ul style="list-style-type: none"> <li>■ <b>Sika Primer-21 W</b><br/>Synthetic resin based primer for preparing porous and non-porous surfaces</li> </ul>  | <b>PRIMERS</b> <ul style="list-style-type: none"> <li>■ <b>Sika Primer-11 W</b><br/>Synthetic resin based primer for preparing gypsum or cementitious surfaces</li> </ul> Or: <ul style="list-style-type: none"> <li>■ <b>Sika Primer-21 W</b><br/>Synthetic resin based primer for preparing porous and non-porous surfaces</li> </ul>  |
| <b>WATERPROOFING LAYER</b> <ul style="list-style-type: none"> <li>■ <b>Sikalastic-152</b><br/>Two-component, polymer modified, fibre-reinforced, cement based, elastic waterproofing mortar, with low modulus that is easy to apply, even in low temperatures.</li> </ul> Or: <ul style="list-style-type: none"> <li>■ <b>Sikalastic-200 W</b><br/>A ready to use, 1 part, solvent-free, liquid waterproof system, which forms a waterproof, flexible, crack-resistant membrane under hard protection ( e.g. tiles or natural stone). Note: not suitable for total immersion e.g. under shower trays. Use in conjunction with <b>Sika Joint Bandage</b></li> </ul> | <b>WATERPROOFING LAYER</b> <ul style="list-style-type: none"> <li>■ <b>Sikalastic-152</b><br/>Two-component, polymer modified, fibre-reinforced, cement based, elastic waterproofing mortar, with low modulus that is easy to apply, even in low temperatures.</li> </ul> Or: <ul style="list-style-type: none"> <li>■ <b>Sikalastic-200 W</b><br/>A ready to use, 1 part, solvent-free, liquid waterproof system, which forms a waterproof, flexible, crack-resistant membrane under hard protection ( e.g. tiles or natural stone). Note: not suitable for total immersion e.g. under shower trays. Use in conjunction with <b>Sika Joint Bandage</b></li> </ul> |
| <b>TILE ADHESIVE</b> <ul style="list-style-type: none"> <li>■ <b>SikaCeram-290 StarLight</b><br/>One-pack adhesive consisting of high resistance cements, high polymer content, selected silicon/quartz mineral sands and specialist additives. It can create deformable adhesive layers up to 15mm thick. Suitable for gres porcelin and natural stone on facades, heated floors, swimming pools and industrial floors.</li> </ul>  | <b>TILE ADHESIVE</b> <ul style="list-style-type: none"> <li>■ <b>SikaCeram-255 StarFlex LD</b><br/>One-pack premixed adhesive consisting of high quality cements, selected silica/quartz sands and specific additives. It achieves highly flexible adhesive layers up to 15 mm thick. It is suitable for gres porcelin and natural stone on façades, heated floors, swimming pools and industrial flooring areas.</li> </ul>   |
| <b>TILE GROUT</b> <ul style="list-style-type: none"> <li>■ <b>SikaCeram StarGrout</b><br/>Two-component, coloured epoxy tile grout, for 2–20 mm joint widths. Watertight, anti-fungal and anti-bacterial, with high chemical and abrasion resistance.</li> </ul>   | <b>TILE GROUT</b> <ul style="list-style-type: none"> <li>■ <b>SikaCeram CleanGrout + SikaCeram LatexGrout</b><br/>Cementitious tile grout for 1–8 mm joint widths. Water resistant, anti-fungal and anti-bacterial, with high abrasion resistance and very stable colours. (Class CG2).</li> </ul>   |
| <b>JOINT SEALANT</b> <ul style="list-style-type: none"> <li>■ <b>Sikasil Color</b><br/>An acetic-crosslinking silicone sealant that is solvent-free and resistant to mildew. Ideal for forming expansion joints between tiles, tubs, sinks, for sealing showers and forming expansion joints between walls and floors</li> </ul>   | <b>JOINT SEALANT</b> <ul style="list-style-type: none"> <li>■ <b>Sikasil Color</b><br/>An acetic-crosslinking silicone sealant that is solvent-free and resistant to mildew. Ideal for forming expansion joints between tiles, tubs, sinks, for sealing showers and forming expansion joints between walls and floors</li> </ul>   |



Scan QR Code for data sheets & SDS on these products

# FACADES

For tiling on façades, Sika has developed tile adhesives and grouts with low modulus that are capable of withstanding exposure to frequent temperature shocks and the different thermal movement of different facade materials. The cementitious adhesives for external façade tiling have a high polymer content and are highly flexible. They are applied in two layers to avoid the presence of air voids under the tiles. The cement based tile grout is waterproof with considerable flexibility, abrasion resistance and high mechanical strength; the grout is mixed with special latex to further increase the performance. Finally, joints and perimeters are sealed aesthetically with a coloured silicone or polyurethane based sealant, which are both elastic and low modulus to be suitable for sealing joints and cracks subject to high movement.

## SIKA TILING SYSTEM FOR FACADES

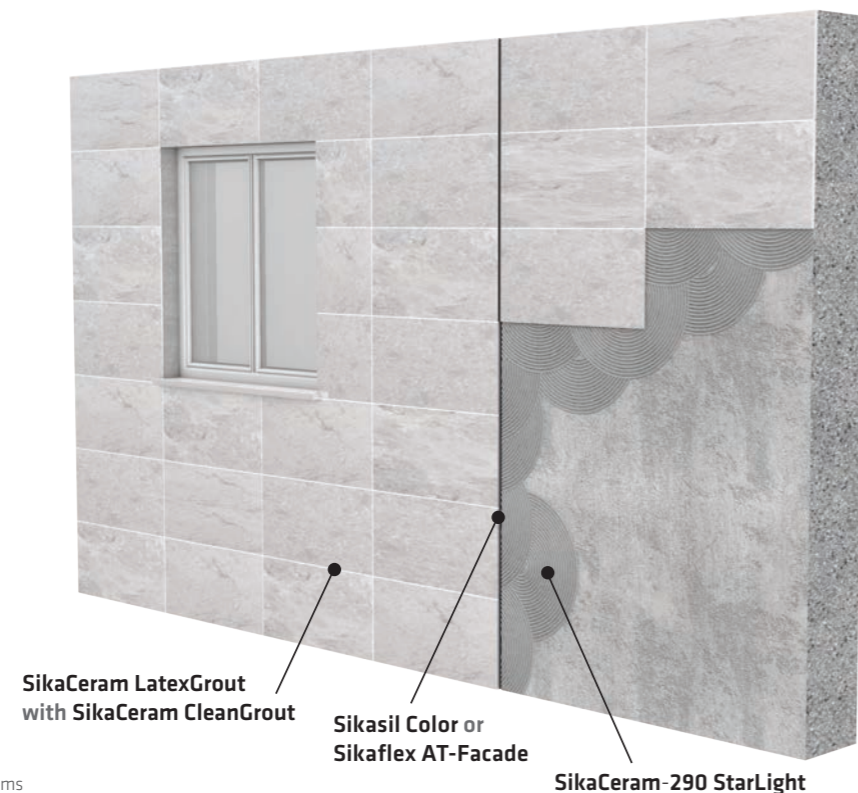
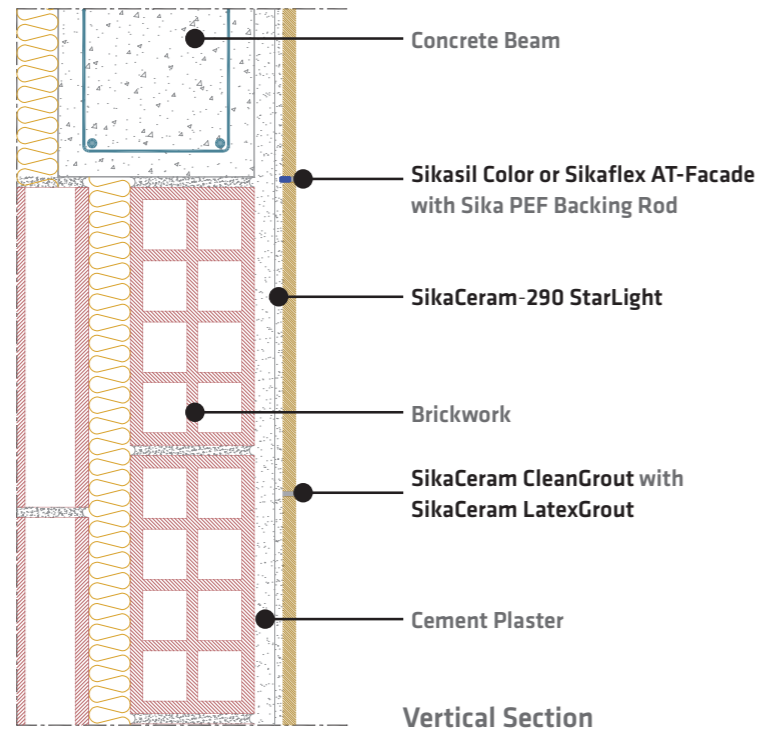

| TILING SYSTEM OPTION 1  | TILING SYSTEM OPTION 2  |
|---|---|
| <b>SURFACE TREATMENT</b> <ul style="list-style-type: none"> <li>■ <b>Sika MonoTop</b><br/>One-component, polymer modified, cementitious repair and levelling mortars to produce a sound and uniform substrate for waterproofing and tiling application.</li> </ul>  | <b>SURFACE TREATMENT</b> <ul style="list-style-type: none"> <li>■ <b>Sika MonoTop</b><br/>One-component, polymer modified, cementitious repair and levelling mortars to produce a sound and uniform substrate for waterproofing and tiling application.</li> </ul>  |
| <b>PRIMERS</b> <ul style="list-style-type: none"> <li>■ <b>Sika Primer-11 W</b><br/>Synthetic resin based primer for preparing gypsum or cementitious surfaces</li> </ul>   | <b>PRIMERS</b> <ul style="list-style-type: none"> <li>■ <b>Sika Primer-11 W</b><br/>Synthetic resin based primer for preparing gypsum or cementitious surfaces</li> </ul>   |
| <b>WATERPROOFING LAYER</b> <ul style="list-style-type: none"> <li>■ <b>Sikalastic-152</b><br/>Two-component, polymer modified, fibre-reinforced, cement based, elastic waterproofing mortar, with low modulus that is easy to apply, even in low temperatures.</li> </ul>   | <b>WATERPROOFING LAYER</b> <ul style="list-style-type: none"> <li>■ <b>Sikalastic-152</b><br/>Two-component, polymer modified, fibre-reinforced, cement based, elastic waterproofing mortar, with low modulus that is easy to apply, even in low temperatures.</li> </ul>   |
| <b>TILE ADHESIVE</b> <ul style="list-style-type: none"> <li>■ <b>SikaCeram-290 StarLight</b><br/>One-pack adhesive consisting of high resistance cements, high polymer content, selected silicon/quartz mineral sands and specialist additives. It can create deformable adhesive layers up to 15mm thick. Suitable for gres porcelin and natural stone on facades, heated floors, swimming pools and industrial floors.</li> </ul>   | <b>TILE ADHESIVE</b> <ul style="list-style-type: none"> <li>■ <b>SikaCeram-100 Basic</b> and <b>SikaCeram T-Latex</b><br/>SikaCeram-100 Basic is a one-pack premixed adhesive. When mixed with SikaCeram T-Latex (instead of water) it improves adhesion and elasticity performance.</li> </ul>   |
| <b>TILE GROUT</b> <ul style="list-style-type: none"> <li>■ <b>SikaCeram CleanGrout</b><br/>Cementitious tile grout for 1-8 mm joint widths. Water resistant, anti-fungal and anti-bacterial, with high abrasion resistance and very stable colours. (Class <b>CG2</b>).</li> <li>■ With the addition of <b>SikaCeram LatexGrout</b> synthetic rubber latex, that is used as a special additive for increasing the performance of cement-based tile grouts. It increases their flexibility and reduces water absorption. (Achieves Class S1.)</li> </ul> | <b>TILE GROUT</b> <ul style="list-style-type: none"> <li>■ <b>SikaCeram CleanGrout</b><br/>Cementitious tile grout for 1-8 mm joint widths. Water resistant, anti-fungal and anti-bacterial, with high abrasion resistance and very stable colours. (Class <b>CG2</b>).</li> <li>■ With the addition of <b>SikaCeram LatexGrout</b> synthetic rubber latex, that is used as a special additive for increasing the performance of cement-based tile grouts. It increases their flexibility and reduces water absorption. (Achieves Class S1.)</li> </ul> |
| <b>JOINT SEALANT</b> <ul style="list-style-type: none"> <li>■ <b>Sikaflex AT-Facade</b><br/>Sikaflex AT-Façade is a 1-part, moisture curing elastic sealant based on Silane Terminated Polymers. Sikaflex AT-Façade is especially formulated for movement and connection joints on porous and non-porous substrates, where excellent weatherability and highest UV resistance are required.</li> </ul>  | <b>JOINT SEALANT</b> <ul style="list-style-type: none"> <li>■ <b>Sikasil Color</b><br/>The Sikasil Color is an acetic-crosslinking silicone sealant that is solvent-free and resistant to mildew. It is suitable for forming expansion joints between tiles, tubs, sinks, for sealing showers and forming expansion joints between walls and floors.</li> </ul>   |



Scan QR Code for data sheets & SDS on these products



# LARGE FORMAT TILES

The laying of large format ceramic and natural stone tiles requires special solutions that Sika provides. A flat surface is achieved with levelling technology designed to avoid separation and imperfections, together with an excellent finish. This is a new generation, high performance, highly flexible, cementitious adhesive, with a high polymer content that is applied in two layers. Then a flexible tile grout with low modulus, and excellent mechanical strength and abrasion resistance is used, together with a high performance silicone or polyurethane based elastic sealant for moving joints and connections.

## SIKA TILING SYSTEM FOR LARGE FORMAT TILES

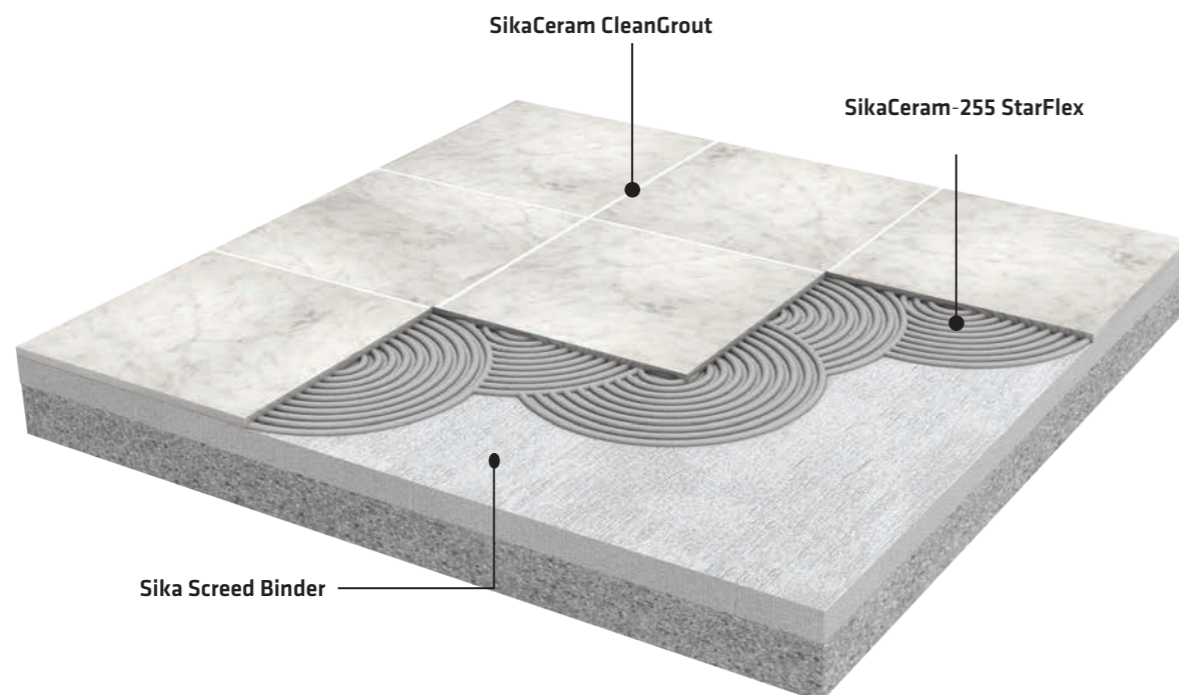
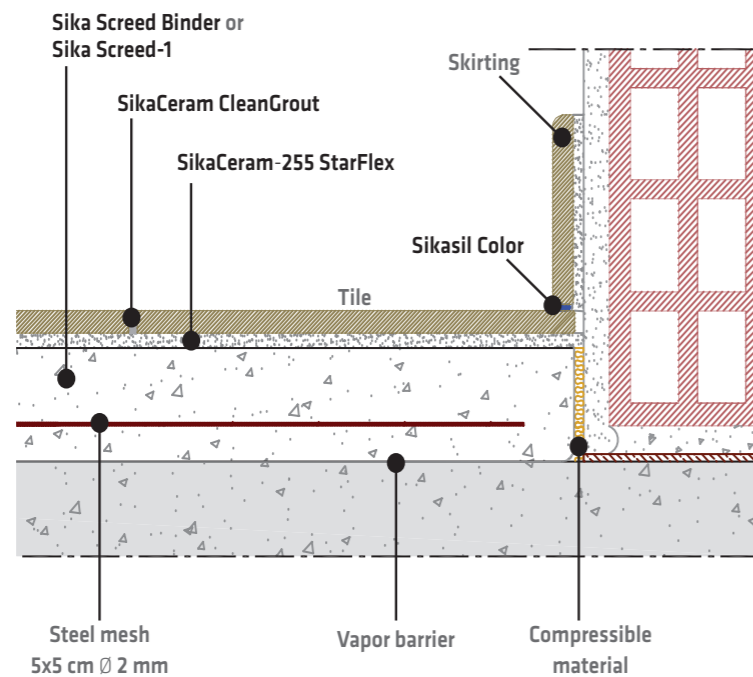

| TILING SYSTEM OPTION 1   | TILING SYSTEM OPTION 2  |
|--|---|
| <p><b>SURFACE TREATMENT &amp; PREPARATION</b></p> <ul style="list-style-type: none"> <li>■ <b>Sika Screed Binder</b><br/>Quick-drying, hydraulic binder used to produce subfloor screeds with normal setting and low shrinkage; for internal and external use.</li> </ul> <p>Or:</p> <ul style="list-style-type: none"> <li>■ <b>Sika Primer-11 W</b><br/>Synthetic resin based primer for preparing gypsum or cementitious surfaces.</li> <li>■ <b>Sika Primer-21 W</b><br/>Synthetic resin based primer for preparing porous and non-porous surfaces.</li> <li>■ <b>Sikafloor Level-15 (NZ)</b><br/>Cementitious self-levelling, fast hardening, underlayment for use 0.5 - 15mm.</li> </ul> | <p><b>SURFACE TREATMENT &amp; PREPARATION</b></p> <ul style="list-style-type: none"> <li>■ <b>Sika Screed-1</b><br/>Pre-mixed fast setting, shrinkage-free screed for external and internal applications.</li> </ul> <p>Or:</p> <ul style="list-style-type: none"> <li>■ <b>Sika Primer-11 W</b><br/>Synthetic resin based primer for preparing gypsum or cementitious surfaces.</li> <li>■ <b>Sika Primer-21 W</b><br/>Synthetic resin based primer for preparing porous and non-porous surfaces.</li> <li>■ <b>Sikafloor Level-15 (NZ)</b><br/>Cementitious self-levelling, fast hardening, underlayment for use 0.5 - 15mm.</li> </ul> |
| <p><b>TILE ADHESIVE</b></p> <ul style="list-style-type: none"> <li>■ <b>SikaCeram-290 StarLight</b><br/>One-pack adhesive consisting of high resistance cements, high polymer content, selected silicon/quartz mineral sands and specialist additives. It can create deformable adhesive layers up to 15mm thick. Suitable for gres porcelin and natural stone on facades, heated floors, swimming pools and industrial floors.</li> </ul>   | <p><b>TILE ADHESIVE</b></p> <ul style="list-style-type: none"> <li>■ <b>SikaCeram-255 StarFlex LD</b><br/>One-pack premixed adhesive consisting of high quality cements, selected silica/quartz sands and specific additives. It achieves highly flexible adhesive layers up to 15 mm thick. It is suitable for grès porcelain and natural stone on façades, heated floors, swimming pools and industrial flooring areas.</li> </ul>  |
| <p><b>TILE GROUT</b></p> <ul style="list-style-type: none"> <li>■ <b>SikaCeram StarGrout</b><br/>Two-component, coloured epoxy tile grout, for 2-20 mm joint widths. Watertight, anti-fungal and anti-bacterial, with high chemical and abrasion resistance. It is suitable for swimming pools including seawater pools, thermal pools, private and public bathrooms. (Class R2T).</li> </ul>  | <p><b>TILE GROUT</b></p> <ul style="list-style-type: none"> <li>■ <b>SikaCeram CleanGrout</b><br/>Cementitious tile grout for 1-8 mm joint widths. Water resistant, anti-fungal and anti-bacterial, with high abrasion resistance and very stable colours. (Class CG2).</li> </ul>  |
| <p><b>JOINT SEALANT</b></p> <ul style="list-style-type: none"> <li>■ <b>Sikasil Color</b><br/>The Sikasil Color is an acetic-crosslinking silicone sealant that is solvent-free and resistant to mildew. It is suitable for forming expansion joints between tiles, tubs, sinks, for sealing showers and forming expansion joints between walls and floors.</li> </ul>   | <p><b>JOINT SEALANT</b></p> <ul style="list-style-type: none"> <li>■ <b>Sikasil Color</b><br/>The Sikasil Color is an acetic-crosslinking silicone sealant that is solvent-free and resistant to mildew. It is suitable for forming expansion joints between tiles, tubs, sinks, for sealing showers and forming expansion joints between walls and floors.</li> </ul>  |



Scan QR Code for data sheets & SDS on these products

# PORCELAIN TILES

Porcelain tiles are an extremely durable type of ceramic tile as they are produced under higher pressure and temperature to be extremely hard and non-absorbent. Therefore they are a typical choice for floors in public and commercial areas that are subject to heavy traffic such as those in Airports, Train Stations, Shopping Centres and Showrooms. For these areas and exposure conditions it is necessary to use a tile installation system that is able to meet and safely accommodate or transfer the high stresses imposed on the floor. This means providing a substrate with high compressive and tensile strengths. The Sika system for porcelain includes a new generation of polymer modified tile adhesive designed for bonding non-absorbent materials. A highly flexible tile grout with good mechanical strengths and abrasion resistance strength should be used, followed by a high performance silicone elastic sealant for any moving joints or connections.

## SIKA TILING SYSTEM FOR PORCELAIN FORMAT TILES

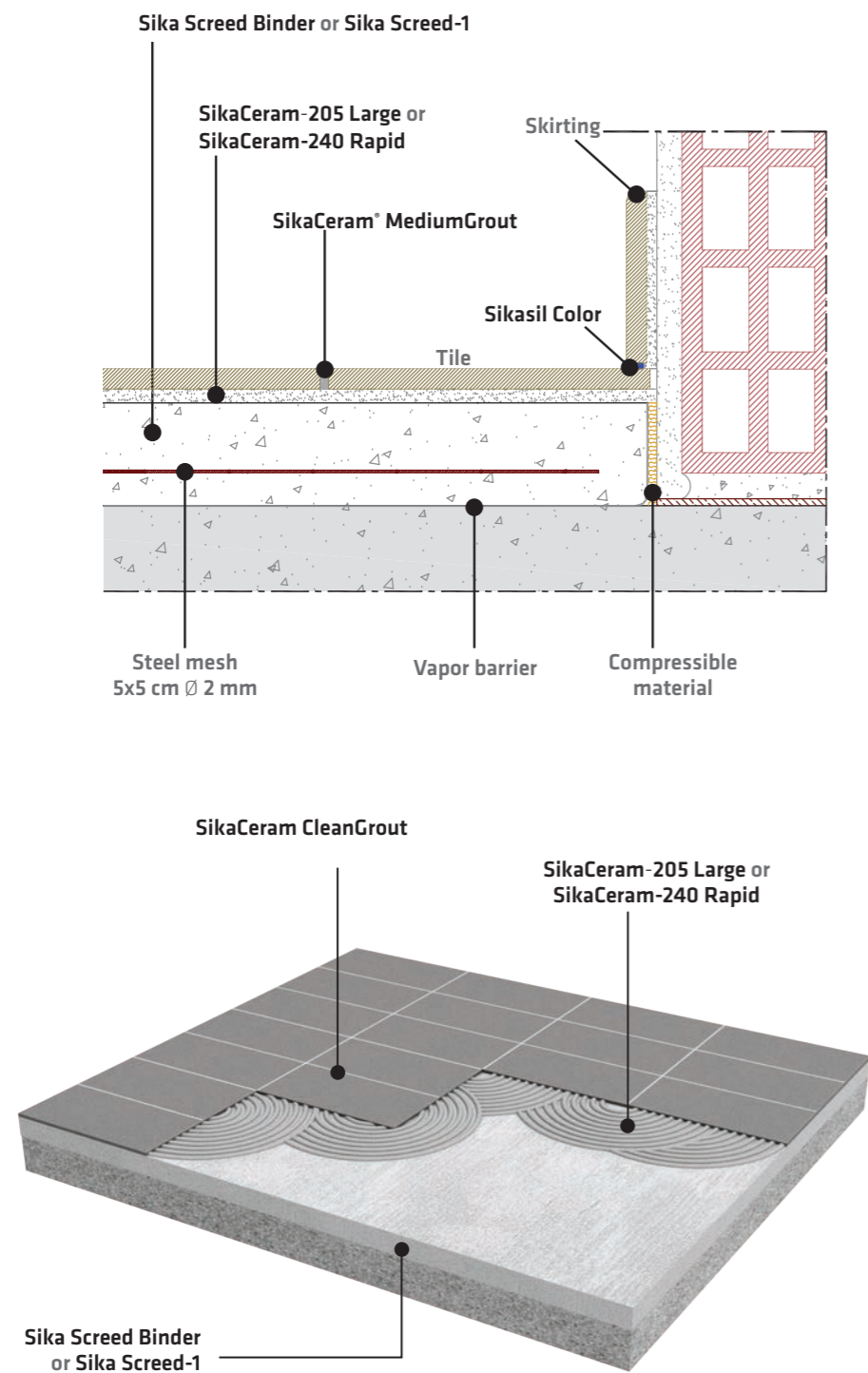

| TILING SYSTEM OPTION 1   | TILING SYSTEM OPTION 2   |
|--|--|
| <b>SURFACE TREATMENT &amp; PREPARATION</b> <ul style="list-style-type: none"> <li>■ <b>Sika Primer-11 W</b><br/>Synthetic resin based primer for preparing gypsum or cementitious surfaces.</li> <li>■ <b>Sika Screed-1</b><br/>Pre-mixed fast setting, shrinkage-free screed for external and internal applications. Ideal for 3 to 6mm thick screeds in civil or industrial environments. It can be covered with tiles, parquet or resilient materials.</li> <li>■ <b>Sikafloor Level-15 (NZ)</b><br/>Cementitious self-levelling, fast hardening, underlayment for use 0.5 - 15mm.</li> </ul> | <b>SURFACE TREATMENT &amp; PREPARATION</b> <ul style="list-style-type: none"> <li>■ <b>Sika Primer-11 W</b><br/>Synthetic resin based primer for preparing gypsum or cementitious surfaces.</li> <li>■ <b>Sika Screed Binder</b><br/>Quick-drying, hydraulic binder used to produce subfloor screeds with normal setting and low shrinkage; suitable for both internal and external use.</li> <li>■ <b>Sikafloor Level-15 (NZ)</b><br/>Cementitious self-levelling, fast hardening, underlayment for use 0.5 - 15mm.</li> </ul>                  |
| <b>TILE ADHESIVE</b> <ul style="list-style-type: none"> <li>■ <b>SikaCeram-290 StarLight</b><br/>One-pack adhesive consisting of high resistance cements, high polymer content, selected silicon/quartz mineral sands and specialist additives. It can create deformable adhesive layers up to 15mm thick. Suitable for gres porcelin and natural stone on facades, heated floors, swimming pools and industrial floors.</li> </ul>  | <b>TILE ADHESIVE</b> <ul style="list-style-type: none"> <li>■ <b>SikaCeram-240 Rapid</b><br/>Quick setting, one-pack powder adhesive to lay ceramic tiles, consisting of high resistance cements, high polymers content, selected silicon/quartz mineral charges and specific additives.</li> </ul>  |
| <b>TILE GROUT</b> <ul style="list-style-type: none"> <li>■ <b>SikaCeram StarGrout</b><br/>Two-component, coloured epoxy tile grout, for 2-20 mm joint widths. Watertight, anti-fungal and anti-bacterial, with high chemical and abrasion resistance. It is suitable for swimming pools including seawater pools, thermal pools, private and public bathrooms. (Class R2T).</li> </ul>   | <b>TILE GROUT</b> <ul style="list-style-type: none"> <li>■ <b>SikaCeram CleanGrout</b><br/>Cementitious tile grout for 1-8 mm joint widths. Water resistant, anti-fungal and anti-bacterial, with high abrasion resistance and very stable colours. (Class CG2).</li> <li>■ With the addition of <b>SikaCeram LatexGrout</b> synthetic rubber latex, that is used as a special additive for increasing the performance of cement-based tile grouts. It increases their flexibility and reduces water absorption. (Achieves Class S1.)</li> </ul> |
| <b>JOINT SEALANT</b> <ul style="list-style-type: none"> <li>■ <b>Sikasil Color</b><br/>Sikasil Color is an acetic-crosslinking silicone sealant that is solvent-free and resistant to mildew. It is suitable for forming expansion joints between tiles, tubs, sinks, for sealing showers and forming expansion joints between walls and floors.</li> </ul>  | <b>JOINT SEALANT</b> <ul style="list-style-type: none"> <li>■ <b>Sikasil Color</b><br/>Sikasil Color is an acetic-crosslinking silicone sealant that is solvent-free and resistant to mildew. It is suitable for forming expansion joints between tiles, tubs, sinks, for sealing showers and forming expansion joints between walls and floors.</li> </ul>  |



Scan QR Code for data sheets & SDS on these products

# SWIMMING POOLS

The installation of tiles in swimming pools has always been considered a critical application and Sika has extensive expertise and experience in this area. Firstly the substrate is repaired and levelled with an appropriate cementitious repair mortar and surface smoothing mortar. Sika then provides a two-component, polymer modified, thixotropic, cementitious waterproofing mortar in two layers, which ensures that durable, long term waterproofing is achieved. A highly flexible cement-based tile adhesive is then used that is able to withstand thermal shock on the substrate, as well as continuous immersion in an alkaline environment. For the tile grouting there is the option of a coloured, waterproof and flexible cementitious grout, which is mixed with a special latex to further increase the mechanical strength, abrasion resistance and its impermeability. Alternatively there is a coloured, two-component, watertight epoxy tile grout with high chemical and abrasion resistance. Finally any moving joints and connections are sealed with a high quality, flexible and chemically resistant, neutral curing silicone joint sealant.

## SIKA TILING SYSTEM FOR SWIMMING POOLS

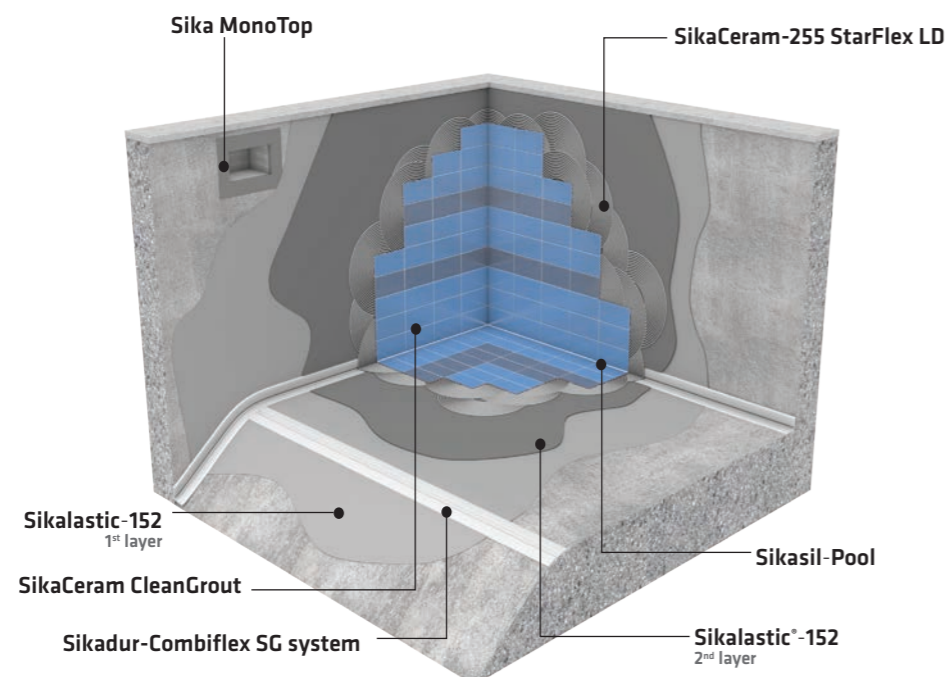
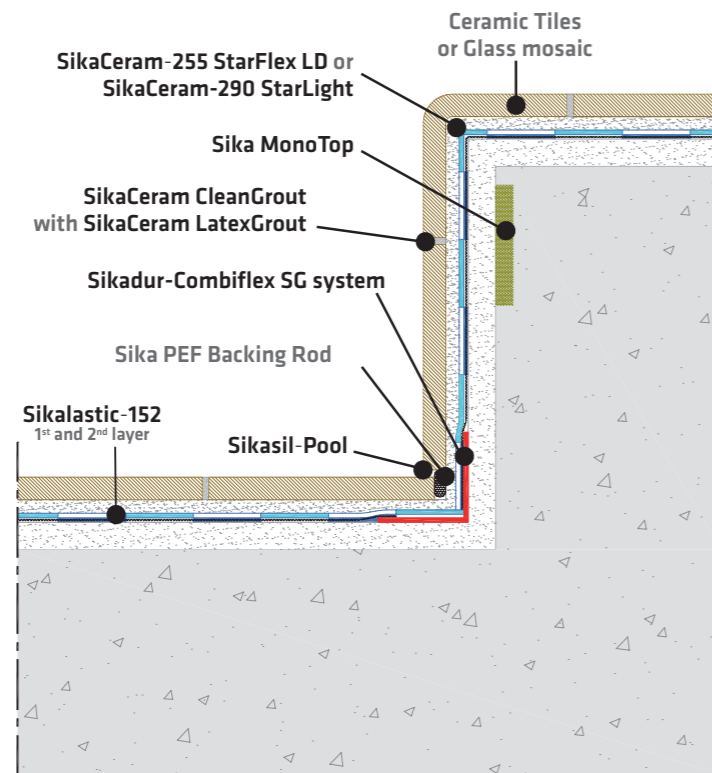

| TILING SYSTEM OPTION 1  | TILING SYSTEM OPTION 2   |
|---|--|
| <b>SURFACE TREATMENT</b> <ul style="list-style-type: none"> <li>■ <b>Sika MonoTop</b><br/>One-component, polymer modified, cementitious repair and levelling mortars for waterproofing and tiling works.</li> </ul>   | <b>SURFACE TREATMENT</b> <ul style="list-style-type: none"> <li>■ <b>Sika MonoTop</b><br/>One-component, polymer modified, cementitious repair and levelling mortars for waterproofing and tiling works.</li> </ul>  |
| <b>WATERPROOFING LAYER</b> <ul style="list-style-type: none"> <li>■ <b>Sikalastic-152</b><br/>Two-component, polymer modified, fibre-reinforced, cement based, elastic waterproofing mortar, with a low modulus that is easy to apply, even in low temperatures.</li> <li>■ <b>Sikadur-Combiflex SG system</b><br/>High performance, watertight sealing system for different types of joints and cracks, plus around penetrations and perimeter edges.</li> </ul> | <b>WATERPROOFING LAYER</b> <ul style="list-style-type: none"> <li>■ <b>Sikalastic-152</b><br/>Two-component, polymer modified, fibre-reinforced, cement based, elastic waterproofing mortar, with a low modulus that is easy to apply, even in low temperatures.</li> <li>■ <b>Sikadur-Combiflex SG system</b><br/>High performance, watertight sealing system for different types of joints and cracks, plus around penetrations and perimeter edges.</li> </ul>    |
| <b>TILE ADHESIVE</b> <ul style="list-style-type: none"> <li>■ <b>SikaCeram-290 StarLight</b><br/>One-pack premixed adhesive consisting of high quality cements, selected silica/quartz sands and specific additives. It achieves highly flexible adhesive layers up to 15 mm thick. It is suitable for grès porcelain and natural stone on façades, heated floors, swimming pools and industrial flooring areas.</li> </ul>                                       | <b>TILE ADHESIVE</b> <ul style="list-style-type: none"> <li>■ <b>SikaCeram-255 StarLight LD</b><br/>One-pack adhesive consisting of high resistance cements, high polymer content, selected silicon/quartz mineral sands and specialist additives. It can create deformable adhesive layers up to 15mm thick. Suitable for grès porcelain and natural stone on facades, heated floors, swimming pools and industrial floors.</li> </ul>                              |
| <b>TILE GROUT</b> <ul style="list-style-type: none"> <li>■ <b>SikaCeram StarGrout</b><br/>Two-component, coloured epoxy tile grout, for 2-20 mm joint widths. Watertight, anti-fungal and anti-bacterial, with high chemical and abrasion resistance</li> </ul>   | <b>TILE GROUT</b> <ul style="list-style-type: none"> <li>■ <b>SikaCeram CleanGrout</b><br/>Cementitious tile grout for 1-8 mm joint widths. Water resistant, anti-fungal and anti-bacterial, with high abrasion resistance and very stable colours. (Class CG2).</li> <li>■ <b>SikaCeram LatexGrout</b><br/>Synthetic rubber latex, used as a special additive for grouts to increase their flexibility and reduce water absorption. (Achieves Class S1).</li> </ul> |
| <b>JOINT SEALANT</b> <ul style="list-style-type: none"> <li>■ <b>Sikasil-Pool</b><br/>Neutral curing, silicone sealant for sealing joints in swimming pools.</li> </ul>   | <b>JOINT SEALANT</b> <ul style="list-style-type: none"> <li>■ <b>Sikasil-Pool</b><br/>Neutral curing, silicone sealant for sealing joints in swimming pools.</li> </ul>  |





# NEW BALCONIES

Tiled finishes on new balconies require careful design and workmanship to prevent common problems such as uneven floor slabs and inadequate dewatering, drainage and waterproofing – especially at joints and penetrations; plus the ability to accommodate rapid temperature changes and thermal movement. Sika uses a hydraulic subfloor screed to ensure a level surface with high mechanical strengths that is also rapid hardening with nearly zero shrinkage. This means that the waterproofing layer can be made with the flexible, polymer modified, cementitious mortar just 24–48 hours after the screed is finished. The cementitious tile adhesives for use on both covered balconies and fully exposed balconies are also flexible and have a high polymer content, which allows them to accommodate thermal shock and movement due to rapid temperature variations. The cementitious tile grouts for external use are also flexible, with a low modulus of elasticity, good mechanical strengths and abrasion resistance. These properties are increased by mixing the grout with our special latex. A high performance, one-component, elastic sealant is used to seal any moving joints or connections.

## SIKA TILING SYSTEM FOR NEW BALCONIES

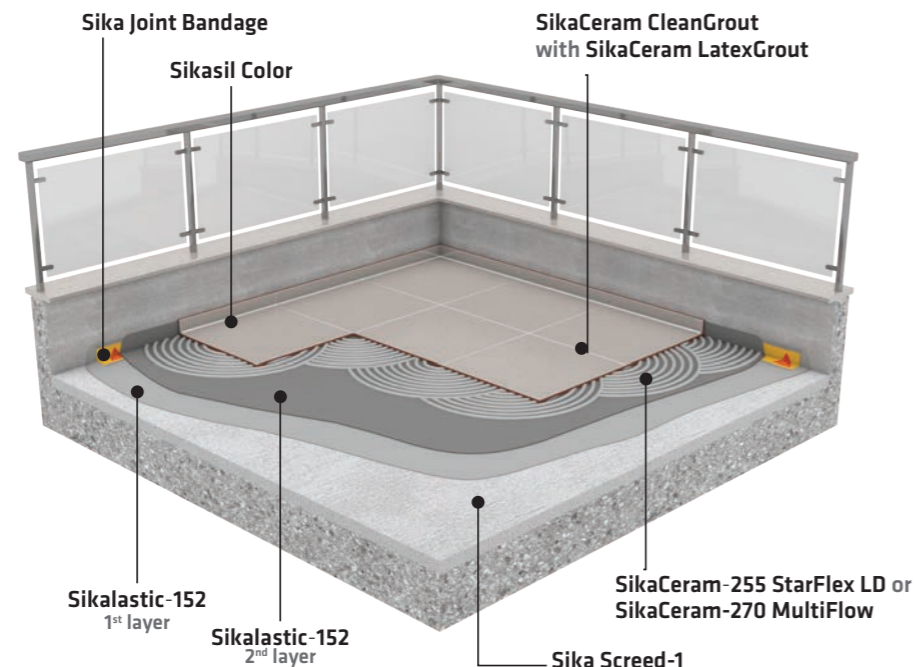
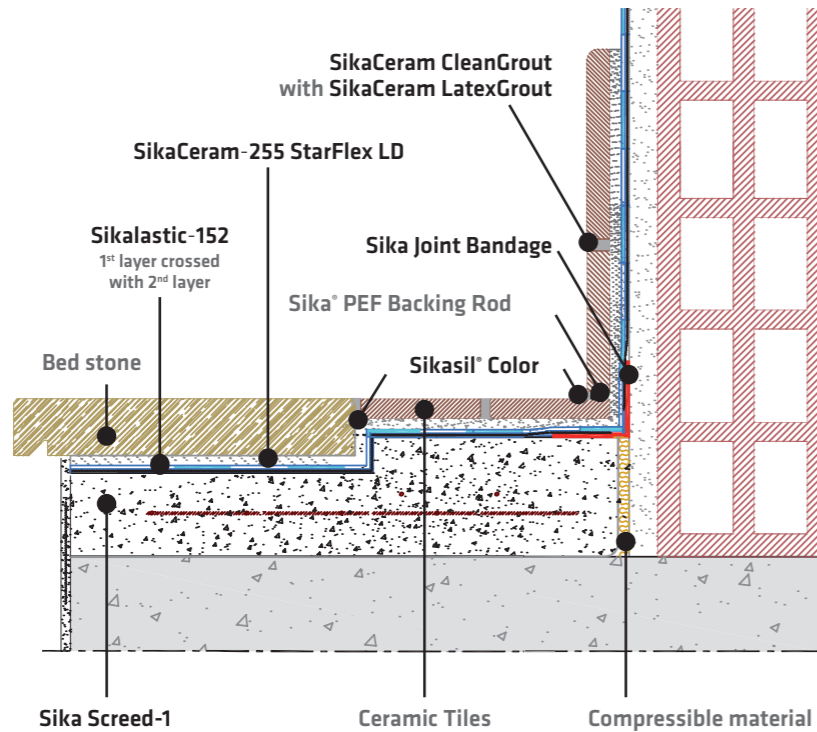

| TILING SYSTEM OPTION 1  | TILING SYSTEM OPTION 2  |
|---|---|
| <b>SURFACE TREATMENT</b> <ul style="list-style-type: none"> <li>■ <b>Sika Screed-1</b><br/>Pre-mixed fast setting, shrinkage-free screed for external and internal applications.</li> </ul>   | <b>SURFACE TREATMENT</b> <ul style="list-style-type: none"> <li>■ <b>Sika Screed Binder</b><br/>Quick-drying, hydraulic binder used to produce subfloor screeds with normal setting and low shrinkage; suitable for both internal and external use.</li> </ul>  |
| <b>PRIMERS</b> <ul style="list-style-type: none"> <li>■ <b>Sika Primer-11 W</b><br/>Synthetic resin based primer for preparing gypsum or cementitious surfaces.</li> </ul> Or: <ul style="list-style-type: none"> <li>■ <b>Sika Primer-21 W</b><br/>Synthetic resin based primer for preparing porous and non-porous surfaces.</li> </ul>   | <b>PRIMERS</b> <ul style="list-style-type: none"> <li>■ <b>Sika Primer-11 W</b><br/>Synthetic resin based primer for preparing gypsum or cementitious surfaces.</li> </ul> Or: <ul style="list-style-type: none"> <li>■ <b>Sika Primer-21 W</b><br/>Synthetic resin based primer for preparing porous and non-porous surfaces.</li> </ul>   |
| <b>WATERPROOFING LAYER</b> <ul style="list-style-type: none"> <li>■ <b>Sikalastic-152</b><br/>Two-component, polymer modified, fibre-reinforced, cement based, elastic waterproofing mortar, with low modulus that is easy to apply, even in low temperatures.</li> <li>■ <b>Sika Joint Bandage</b><br/>Elastic joint sealing tape to waterproof and seal across joints, around fittings and penetrations, and at the perimeter edges of the wet area.</li> </ul>   | <b>WATERPROOFING LAYER</b> <ul style="list-style-type: none"> <li>■ <b>Sikalastic-152</b><br/>Two-component, polymer modified, fibre-reinforced, cement based, elastic waterproofing mortar, with low modulus that is easy to apply, even in low temperatures.</li> <li>■ <b>Sika Joint Bandage</b><br/>Elastic joint sealing tape to waterproof and seal across joints, around fittings and penetrations, and at the perimeter edges of the wet area.</li> </ul> |
| <b>TILE ADHESIVE</b> <ul style="list-style-type: none"> <li>■ <b>SikaCerem-270 MultiFlow</b><br/>High coverage, deformable, fast-setting one-pack premixed adhesive with lightweight fillers, consisting of cements with high mechanical resistance, high polymers content, selected silicon/quartz mineral charges and specific additives. (Class <b>C2 FTE S1</b>)</li> </ul>   | <b>TILE ADHESIVE</b> <ul style="list-style-type: none"> <li>■ <b>SikaCerem-255 StarFlex LD</b><br/>One-pack premixed adhesive consisting of high quality cements, selected silica/quartz sands and specific additives. It achieves highly flexible adhesive layers up to 15 mm thick. It is suitable for grès porcelain and natural stone on façades, heated floors, swimming pools and industrial flooring areas.</li> </ul>                                     |
| <b>TILE GROUT</b> <ul style="list-style-type: none"> <li>■ <b>SikaCerem CleanGrout</b><br/>Cementitious tile grout for 1–8 mm joint widths. Water resistant, anti-fungal and anti-bacterial, with high abrasion resistance and very stable colours. (Class <b>CG2</b>).</li> <li>■ With the addition of <b>SikaCerem LatexGrout</b> synthetic rubber latex, that is used as a special additive for increasing the performance of cement-based tile grouts. It increases their flexibility and reduces water absorption. (Achieves Class S1.)</li> </ul> | <b>TILE GROUT</b> <ul style="list-style-type: none"> <li>■ <b>SikaCerem StarGrout</b><br/>Two-component, coloured epoxy tile grout, for 2–20 mm joint widths. Watertight, anti-fungal and anti-bacterial, with high chemical and abrasion resistance.</li> </ul>  |
| <b>JOINT SEALANT</b> <ul style="list-style-type: none"> <li>■ <b>Sikasil Color</b><br/>The Sikasil Color is an acetic-crosslinking silicone sealant that is solvent-free and resistant to mildew. It is suitable for forming expansion joints between tiles, tubs, sinks, for sealing showers and forming expansion joints between walls and floors.</li> </ul>   | <b>JOINT SEALANT</b> <ul style="list-style-type: none"> <li>■ <b>Sikasil Color</b><br/>The Sikasil Color is an acetic-crosslinking silicone sealant that is solvent-free and resistant to mildew. It is suitable for forming expansion joints between tiles, tubs, sinks, for sealing showers and forming expansion joints between walls and floors.</li> </ul>   |



Scan QR Code for data sheets & SDS on these products



# EXISTING TILED BALCONIES

The penetration of water from exposed external surfaces including terraces and balconies is one of the most common causes for the degradation of buildings. Fortunately there are Sika solutions that enable you to repair and upgrade these areas quickly and for a comparatively low cost without completely removing the existing finishes. After removing any loose, existing tiles and grout and thoroughly cleaning the surface, Sika has the complete refurbishment system including: thixotropic repair mortars to patch and restore the levels; self-levelling mortars; flexible and durable waterproofing layers and cementitious tile adhesives designed for external use. Completing this system are flexible, waterproof, cement-based tile grouts with high mechanical strengths and abrasion resistance. These are mixed with a special latex to further improve performance and achieve the Class S1 according to EN 12002. A high performance, permanently elastic, polyurethane sealant is then used for sealing any moving joints and connections.

## SIKA TILING SYSTEM FOR RENOVATION OF EXISTING TILED BALCONIES

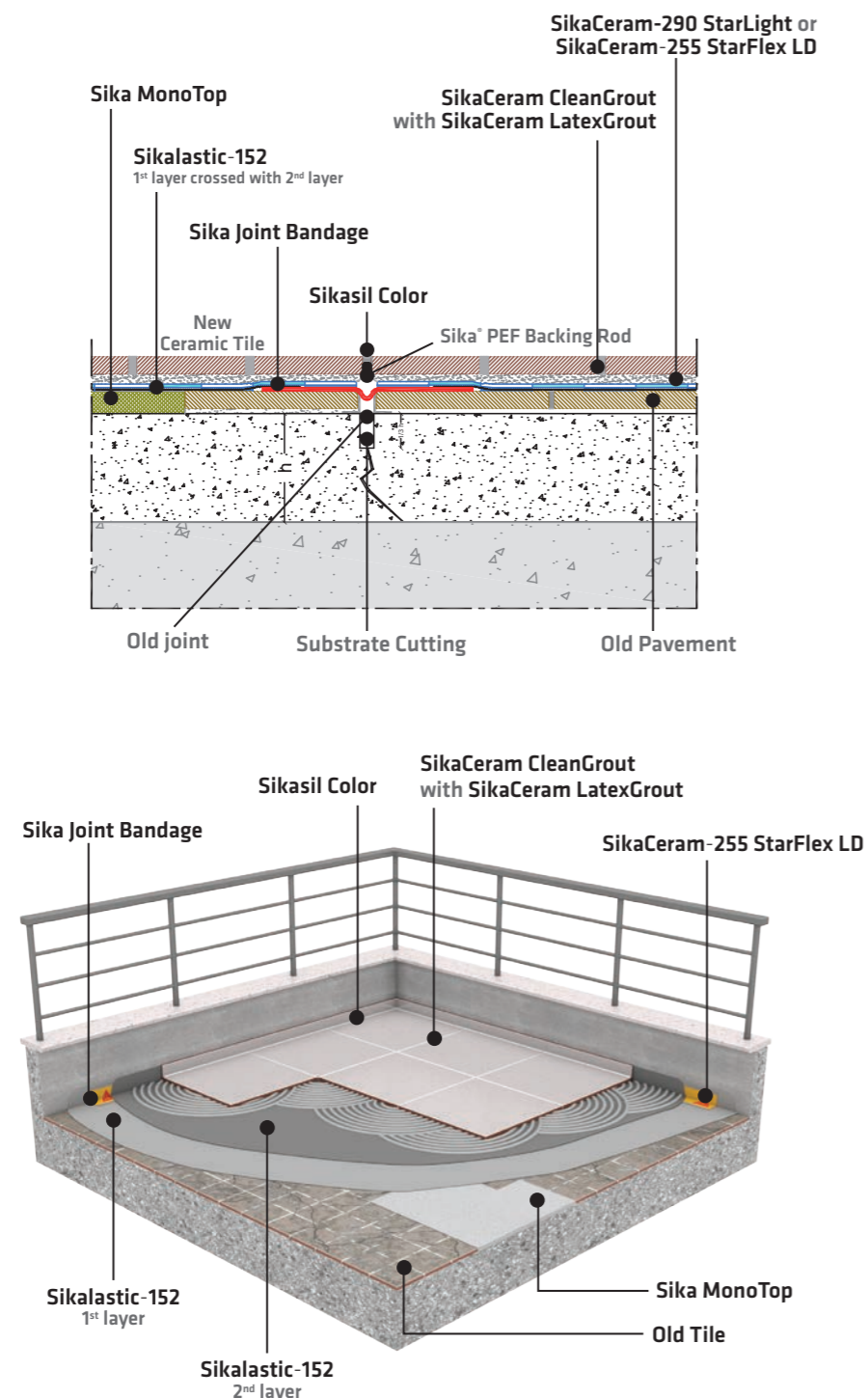

| TILING SYSTEM OPTION 1   | TILING SYSTEM OPTION 2   |
|--|--|
| <p><b>SURFACE TREATMENT</b></p> <ul style="list-style-type: none"> <li>■ <b>Sika MonoTop</b><br/>One-component, polymer modified, cementitious repair and levelling mortars to produce a sound and uniform substrate for waterproofing and tiling application.</li> </ul>  | <p><b>SURFACE TREATMENT</b></p> <ul style="list-style-type: none"> <li>■ <b>Sika MonoTop</b><br/>One-component, polymer modified, cementitious repair and levelling mortars to produce a sound and uniform substrate for waterproofing and tiling application.</li> </ul>  |
| <p><b>WATERPROOFING LAYER</b></p> <ul style="list-style-type: none"> <li>■ <b>Sikalastic-152</b><br/>Two-component, polymer modified, fibre-reinforced, cement based, elastic waterproofing mortar, with low modulus that is easy to apply, even in low temperatures.</li> <li>■ <b>Sika Joint Bandage</b><br/>Elastic joint sealing tape to waterproof and seal across joints, around fittings and penetrations, and at the perimeter edges of the wet area.</li> </ul>   | <p><b>WATERPROOFING LAYER</b></p> <ul style="list-style-type: none"> <li>■ <b>Sikalastic-152</b><br/>Two-component, polymer modified, fibre-reinforced, cement based, elastic waterproofing mortar, with low modulus that is easy to apply, even in low temperatures.</li> <li>■ <b>Sika Joint Bandage</b><br/>Elastic joint sealing tape to waterproof and seal across joints, around fittings and penetrations, and at the perimeter edges of the wet area.</li> </ul>   |
| <p><b>TILE ADHESIVE</b></p> <ul style="list-style-type: none"> <li>■ <b>SikaCeram-290 StarLight</b><br/>One-pack adhesive consisting of high resistance cements, high polymer content, selected silicon/quartz mineral sands and specialist additives. It can create deformable adhesive layers up to 15mm thick. Suitable for gres porcelain and natural stone on facades, heated floors, swimming pools and industrial floors.</li> </ul>  | <p><b>TILE ADHESIVE</b></p> <ul style="list-style-type: none"> <li>■ <b>SikaCeram-255 StarFlex LD</b><br/>One-pack premixed adhesive consisting of high quality cements, selected silica/quartz sands and specific additives. It achieves highly flexible adhesive layers up to 15 mm thick. It is suitable for grès porcelain and natural stone on façades, heated floors, swimming pools and industrial flooring areas.</li> </ul>   |
| <p><b>TILE GROUT</b></p> <ul style="list-style-type: none"> <li>■ <b>SikaCeram CleanGrout</b><br/>Cementitious tile grout for 1-8 mm joint widths. Water resistant, anti-fungal and anti-bacterial, with high abrasion resistance and very stable colours. (Class <b>CG2</b>).</li> <li>■ With the addition of <b>SikaCeram LatexGrout</b> synteheic rubber latex, that is used as a special additive for increasing the performance of cement-based tile grouts. It increases their flexibility and reduces water absorption. (Achieves Class S1.)</li> </ul> | <p><b>TILE GROUT</b></p> <ul style="list-style-type: none"> <li>■ <b>SikaCeram CleanGrout</b><br/>Cementitious tile grout for 1-8 mm joint widths. Water resistant, anti-fungal and anti-bacterial, with high abrasion resistance and very stable colours. (Class <b>CG2</b>).</li> <li>■ With the addition of <b>SikaCeram LatexGrout</b> synteheic rubber latex, that is used as a special additive for increasing the performance of cement-based tile grouts. It increases their flexibility and reduces water absorption. (Achieves Class S1.)</li> </ul> |
| <p><b>JOINT SEALANT</b></p> <ul style="list-style-type: none"> <li>■ <b>Sikasil Color</b><br/>The Sikasil Color is an acetic-crosslinking silicone sealant that is solvent-free and resistant to mildew. It is suitable for forming expansion joints between tiles, tubs, sinks, for sealing showers and forming expansion joints between walls and floors.</li> </ul>   | <p><b>JOINT SEALANT</b></p> <ul style="list-style-type: none"> <li>■ <b>Sikasil Color</b><br/>The Sikasil Color is an acetic-crosslinking silicone sealant that is solvent-free and resistant to mildew. It is suitable for forming expansion joints between tiles, tubs, sinks, for sealing showers and forming expansion joints between walls and floors.</li> </ul>   |



Scan QR Code for data sheets & SDS on these products

# MARBLE, GRANITE & NATURAL STONE TILES

Sika provides a system for the laying of marble, granite and other natural stone tiles which are not sensitive to moisture: subfloor screeds made with a hydraulic binder that ensure high compressive and tensile strengths, and are rapid hardening with very low shrinkage, allowing installation of the tiles after only 24–48 hours from finishing the screed. This is followed by a new generation flexible, cementitious tile adhesive, with a high polymer content and a low modulus. Then flexible, cement-based grouts with high mechanical strengths and abrasion resistance are used, together with permanently elastic, polyurethane based sealants for any moving joints and connections.

## SIKA TILING SYSTEM FOR NATURAL STONE

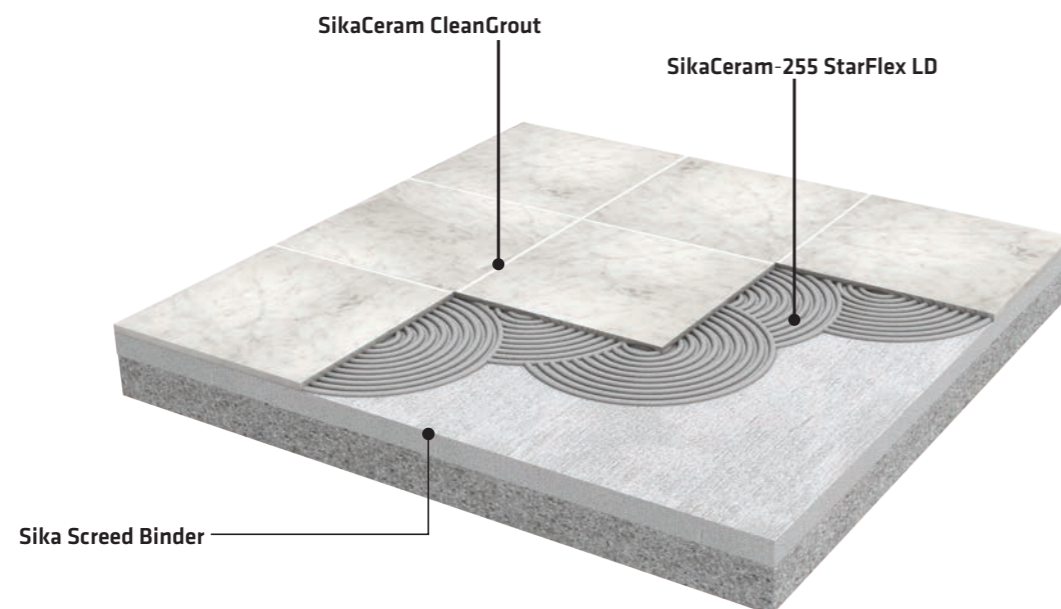
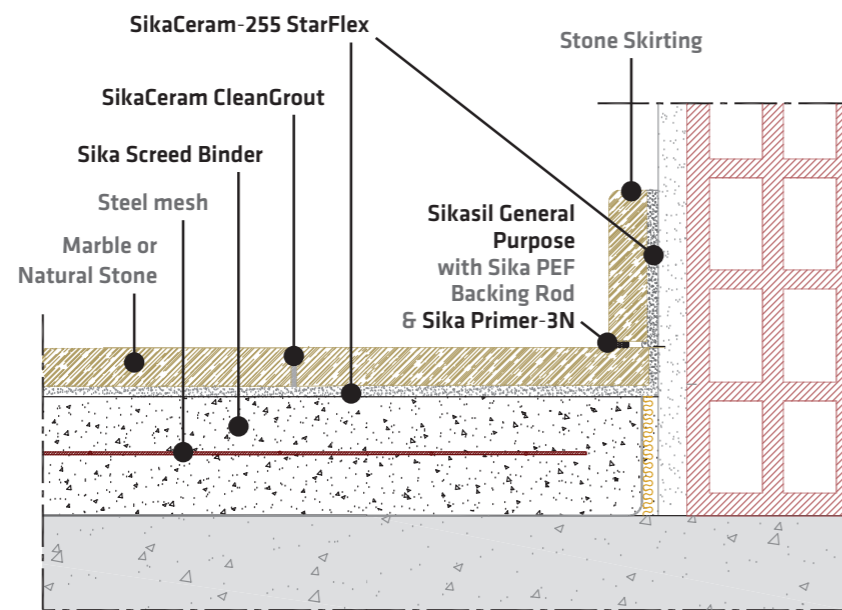

| TILING SYSTEM OPTION 1   | TILING SYSTEM OPTION 2  |
|--|---|
| <b>SURFACE TREATMENT &amp; PREPARATION</b> <ul style="list-style-type: none"> <li>■ <b>Sika Screed-1</b><br/>Pre-mixed fast setting, shrinkage-free screed for external and internal applications.</li> <li>■ <b>Sika Primer-11 W</b><br/>Synthetic resin based primer for preparing gypsum or cementitious surfaces.</li> <li>■ <b>Sika Primer-21 W</b><br/>Synthetic resin based primer for preparing porous and non-porous surfaces.</li> <li>■ <b>Sikafloor Level-15 (NZ)</b><br/>Cementitious self-levelling, fast hardening, underlayment for use 0.5 - 15mm.</li> </ul> | <b>SURFACE TREATMENT &amp; PREPARATION</b> <ul style="list-style-type: none"> <li>■ <b>Sika Screed Binder</b><br/>Quick-drying, hydraulic binder used to produce subfloor screeds with normal setting and low shrinkage; for internal and external use.</li> <li>■ <b>Sika Primer-11 W</b><br/>Synthetic resin based primer for preparing gypsum or cementitious surfaces.</li> <li>■ <b>Sika Primer-21 W</b><br/>Synthetic resin based primer for preparing porous and non-porous surfaces.</li> <li>■ <b>Sikafloor Level-15 (NZ)</b><br/>Cementitious self-levelling, fast hardening, underlayment for use 0.5 - 15mm.</li> </ul> |
| <b>TILE ADHESIVE</b> <ul style="list-style-type: none"> <li>■ <b>SikaCerem-270 MultiFlow</b><br/>High coverage, deformable, fast-setting one-pack premixed adhesive with lightweight fillers, consisting of cements with high mechanical resistance, high polymers content, selected silicon/quartz mineral charges and specific additives.</li> </ul>   | <b>TILE ADHESIVE</b> <ul style="list-style-type: none"> <li>■ <b>SikaCerem-255 StarFlex LD</b><br/>High performance, highly flexible tile adhesive with a high polymer content suitable for up to 15 mm thick ceramic tiles and natural stone tiles, including large format tiles. Designed for tiling on façades, over underfloor heating, in swimming pools and for industrial floors (Class <b>C2TE-S1</b>).</li> </ul>  |
| <b>TILE GROUT</b> <ul style="list-style-type: none"> <li>■ <b>SikaCerem StarGrout</b><br/>Two-component, coloured epoxy tile grout, for 2-20 mm joint widths. Watertight, anti-fungal and anti-bacterial, with high chemical and abrasion resistance. (Class <b>R2T</b>).</li> </ul>   | <b>TILE GROUT</b> <ul style="list-style-type: none"> <li>■ <b>SikaCerem CleanGrout</b><br/>Cementitious tile grout for <b>1-8 mm</b> joint widths. Water resistant, anti-fungal and anti-bacterial, with high abrasion resistance and very stable colours. (Class <b>CG2</b>).</li> </ul>   |
| <b>JOINT SEALANT</b> <ul style="list-style-type: none"> <li>■ <b>Sikasil General Purpose</b><br/>Sikasil General Purpose is a one-component neutral curing silicone sealant suitable for indoor and outdoor applications. It is used as a joint sealant between a variety of substrates.</li> </ul>  | <b>JOINT SEALANT</b> <ul style="list-style-type: none"> <li>■ <b>Sikasil General Purpose</b><br/>Sikasil General Purpose is a one-component neutral curing silicone sealant suitable for indoor and outdoor applications. It is used as a joint sealant between a variety of substrates.</li> </ul>   |
| <ul style="list-style-type: none"> <li>■ <b>Sika Primer-3N</b><br/>One-component, epoxy combination primer to seal porous or absorbent joint substrates in exposed situations before application of the Sika joint sealant.</li> </ul>   | <ul style="list-style-type: none"> <li>■ <b>Sika Primer-3N</b><br/>One-component, epoxy combination primer to seal porous or absorbent joint substrates in exposed situations before application of the Sika joint sealant.</li> </ul>  |



Scan QR Code for data sheets & SDS on these products



# STANDARDS FOR TILE ADHESIVES & GROUTS

## TILE ADHESIVES

### STANDARD EN 12004

This standard establishes the specifications and methods for classifying of adhesives for ceramic tile and similar material on floors and walls.

|                |  |
|----------------|--|
| <b>C</b>       | Cement-base Adhesives in powder form: to be mixed with water or some other appropriate liquid right before use       |
| <b>D</b>       | Dispersion Adhesives: ready-to-use pastes based on organic polymers in water dispersion                              |
| <b>R</b>       | Reactive Adhesives: based on two or more components to be mixed before use, which sets by means of chemical reaction |
| <b>Class 1</b> | Normal adhesives (with minimum criteria)   |
| <b>Class 2</b> | Improved adhesives (with additional criteria)  |
| <b>F</b>       | Fast setting adhesives   |
| <b>T</b>       | Thixotropic adhesives (withstand slip)   |
| <b>E</b>       | Extended (longer) open time adhesives  |

### STANDARD EN 12002

This standard determines the transverse deformation degree (elasticity) of cement-based adhesives and grouts, and divides them into two categories.

|           |  |
|-----------|--|
| <b>S1</b> | Deformable product with $\geq 2.5$ mm deformability      |
| <b>S2</b> | Highly deformable product with $\geq 5$ mm deformability |

## TILE GROUT

### STANDARD EN 13888

This standard establishes the specifications and methods for classifying grouts for ceramic tiles and similar material on floors and walls. It divides the grouts into two categories:

|           |   |
|-----------|---|
| <b>CG</b> | Cement-based Grouts: in powder form, to be mixed with water or some other appropriate liquid right before use     |
| <b>RG</b> | Reactive Grouts: based on two or more components to be mixed before use, which sets by means of chemical reaction |

There are two classes of cementitious grouts (CG), depending on different additional criteria:

|                |  |
|----------------|--|
| <b>Class 1</b> | Normal grouts (with minimum criteria)  |
| <b>Class 2</b> | Improved grouts (with additional criteria, reduced water absorption and high resistance to abrasion) |

# BRANZ APPRAISALS Sikalastic®-152 & Sikalastic®-200 W

**BRANZ Appraised**  
Appraisal No.811 [2013]

**BRANZ Appraisals**  
Technical Assessments of products for building and construction

**BRANZ APPRAISAL No. 811 (2013)**

**SIKALASTIC – 152 EXTERIOR WATERPROOFING MEMBRANE**

Sika (NZ) Ltd  
P O Box 19192  
Auckland  
Tel: 0800 SIKAZ NZ  
Fax: 0800 SIKAZ FAX  
Web: www.sika.co.nz

**BRANZ**  
BRANZ Limited  
Private Bag 908  
Porirua City  
New Zealand  
Tel: +64 4 231 1170  
Fax: +64 4 231 1171  
www.branz.co.nz

**WFTAO**

Readers are advised to check the validity of this Appraisal by referring to the Valid Appraisal listing on the BRANZ website, or by contacting BRANZ.

### BRANZ APPRAISAL NO. 811 [2013] Sikalastic-152 EXTERIOR WATERPROOFING MEMBRANE

Scan the QR Code for a copy of BRANZ Appraisal No. 811 [2013]



**BRANZ Appraised**  
Appraisal No.812 [2013]

**BRANZ Appraisals**  
Technical Assessments of products for building and construction

**BRANZ APPRAISAL No. 812 (2013)**

**SIKALASTIC – 152 AND SIKALASTIC – 200 W INTERIOR WATERPROOFING MEMBRANES**

Sika (NZ) Ltd  
P O Box 19192  
Auckland  
Tel: 0800 SIKAZ NZ  
Fax: 0800 SIKAZ FAX  
Web: www.sika.co.nz

**BRANZ**  
BRANZ Limited  
Private Bag 908  
Porirua City  
New Zealand  
Tel: +64 4 231 1170  
Fax: +64 4 231 1171  
www.branz.co.nz

**WFTAO**

Readers are advised to check the validity of this Appraisal by referring to the Valid Appraisal listing on the BRANZ website, or by contacting BRANZ.

### BRANZ APPRAISAL NO. 812 [2013] Sikalastic-152 AND Sikalastic-200 W INTERIOR WATERPROOFING MEMBRANES

Scan the QR Code for a copy of BRANZ Appraisal No. 812 [2013]





# SIKA TILE INSTALLATION SYSTEMS AT YOUR FINGERTIPS ON THE WEB

Just scan this QR code and it will take you to the right spot, or simply go to [www.sika.co.nz](http://www.sika.co.nz), click on **SOLUTIONS/PRODUCTS**, then choose **TILING SYSTEMS**.



Here you will find links to all the different applications - pools, facades, wet areas, etc. Each 'tile' will take you through to the products for those applications, with access to data sheets, safety data sheets (MSDSs), etc.

## INTERACTIVE TOOLS

There are also some helpful extra features online...just scan the QR codes shown here alongside to access them! (You can also find them easily online on the main Tiling page as seen in the picture to your right!)

### ADHESIVE CALCULATOR

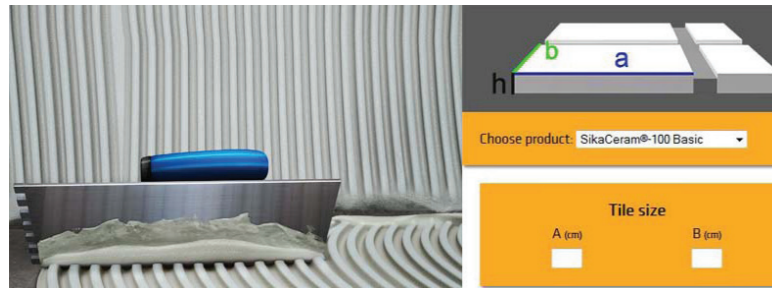

Just choose the SikaCeram adhesive you're using from the drop-down box, enter the tile size and the area to be tiled, and it will calculate for you how many bags you need.



### GROUT CALCULATOR



Just choose the SikaCeram grout you're using from the drop-down box, enter the tile size, area to be tiled and the gap size between tiles, and it will calculate for you how many bags you need.



### GROUT COLOUR SELECTOR

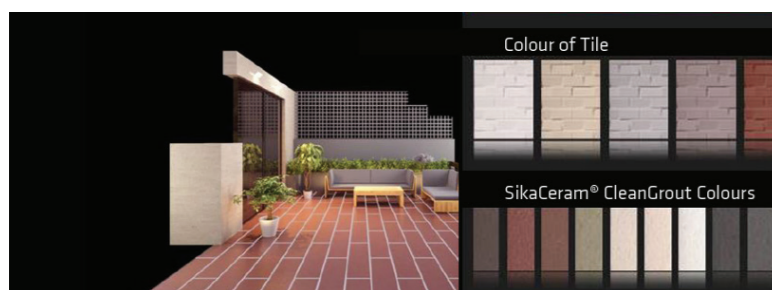

This is an interactive tool that allows you to select an area (ie. bathroom, pool, balcony), then try different tile and grout colour combinations to give you an idea of how your project could look.





# BUILDING TRUST FROM BASEMENT TO ROOF

STRUCTURAL GLAZING

SEALING & BONDING

FLOORING & COATINGS

TILING SYSTEMS

ROOFING

GREEN ROOFING

WATERPROOFING

REPAIR & PROTECTION

SEISMIC STRENGTHENING

CONCRETE

Global expertise, local support, one phone call, problem solved.



## WHO WE ARE

Sika AG, Switzerland, is a globally active specialty chemicals company. Sika supplies the building and construction industry as well as manufacturing industries (automotive, bus, truck, rail, solar and wind power plants, façades). Sika is a leader in processing materials used in sealing, bonding, damping, reinforcing and protecting loadbearing structures. Sika's product lines feature high quality concrete admixtures, specialty mortars, sealants and adhesives, damping and reinforcing materials, structural strengthening systems, industrial flooring as well as roofing and waterproofing systems.

**SIKA (NZ) LTD**  
PO BOX 19192  
Avondale, Auckland  
1746, New Zealand

**Contact**  
Phone 0800 745 269  
Fax 0800 745 232  
[www.sika.co.nz](http://www.sika.co.nz)

**BUILDING TRUST**

