

AQUAMOX BASE SPEC SHEET

PRODUCT OVERVIEW

Aquamox Bases are the solution to an affordable, easy to install tile over base that follows industry installation methods and product testing. Aquamox Bases come in a wide range of common sizes while still remaining easy to customise and modify. Suited to all floor and wall types, Aquamox Bases are adaptable to new builds and renovations alike.

Aquamox Bases offer a 10 year product warranty and with it's mortar reinforcement and high density polystyrene construction means it has greater rigidity and sturdiness - this in turn means no on site damage during installation.

A pre sloped base replaces the traditional scree and mortar process, saving hours of application and curing time on site.

With standard LH and RH corner and Alcove configurations, and Centre and Channel Waste drain options, Aquamox Bases offer the perfect solution for any tile over shower.

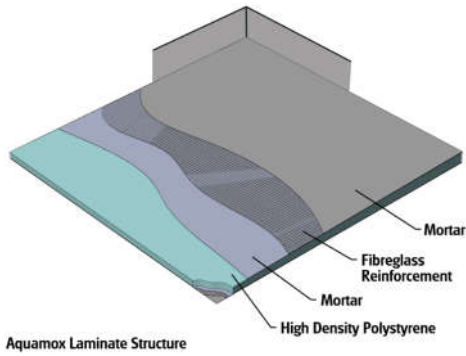
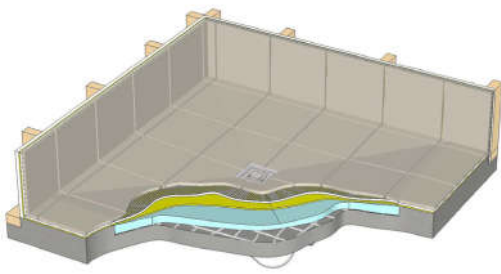

Aquamox Laminate Structure



PRODUCT HIGHLIGHTS

10 YEAR PRODUCT WARRANTY

HIGH DENSITY POLYSTYRENE

MORTAR AND FIBREGLASS REINFORCED

60X60 MM HOB

CHANNEL OR CENTRE WASTE REBATE

MINIMUM 4% FALL RATIO (PRE SLOPED BASE)

COMPLETELY CUSTOMISABLE

LEVEL ENTRY OPTION



60 x 60mm Hob



High Density Reinforced Polystyrene



Channel Waste Option



Centre Waste Option

IS THIS BASE FOR ME?

Aquamox suits a wide variety of wet room and tile over shower spaces. Adaptable and customisable, Aquamox will suit you if you are looking for an affordable solution for a tile over shower base. Uncomplicated in it's installation, Aquamox uses industry standard waterproofing practices, providing you with a safe and easy to use product. Aquamox is designed to suit limitless styles, sizes and modifications so if you have a difficult space to work with or something that needs a made to suit base, then Aquamox is the perfect solution. Aquamox also gives you peace of mind and control over exactly what you need for your shower. With a fast turn around, Aquamox bases are time saving, cost effective and hassle free - ensuring an easy installation process.