

D-Mobile

DAIKIN MOBILE CONTROLLER



Always in control ...

no matter where you are

The D-Mobile app lets you set, monitor and schedule the temperature in your house whether you are on the couch or away from home, offering you optimal climate control while saving energy.

D-Mobile puts your wall mounted air conditioner's frequently used functions at your finger tip with an easy to use app. In conjunction with Daikin's BRP072A42 wireless LAN adaptor, the D-Mobile app lets you use your smartphone or tablet to operate your Daikin wall mounted air conditioning unit via Wi-Fi or the internet.

The wireless adaptor is included with the Zena and is an optional extra for the US7 and Cora Range.



ONLINE CONTROL



REMOTE CONTROL



Always in control ... no matter where you are

Control every room in the house. Turn units on or off individually or all at once.

Set the operation mode, temperature, air purification, airflow, rate and direction.

Schedule the set temperature and operation mode with up to 4 actions per day for 7 days.

Leave home with confidence. Vacation mode turns all units off and puts your schedule on hold.

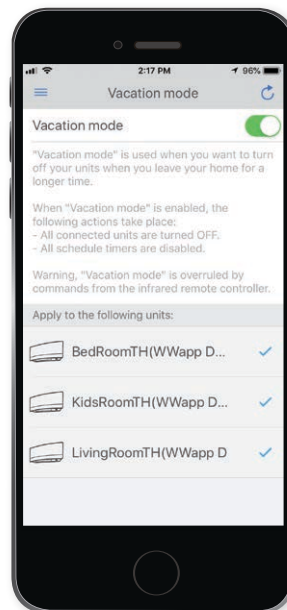
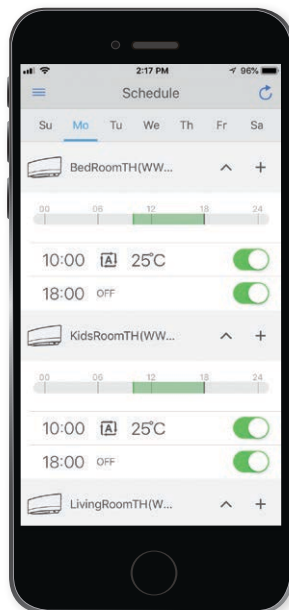
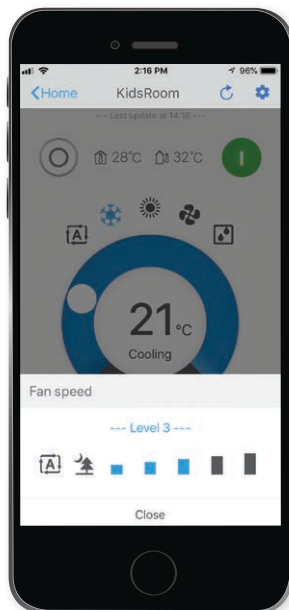
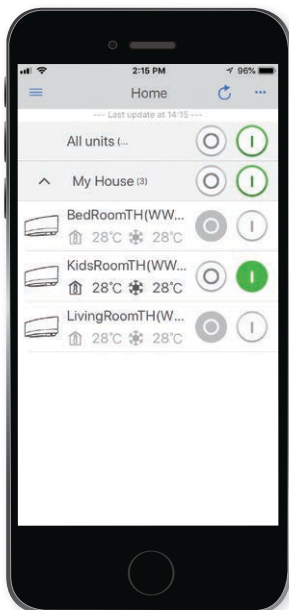

Direct Connection

For locations without an internet connection the app can wirelessly connect directly to the wireless LAN adapter when in range. This means when you're at home you can operate your air conditioner via your smartphone without needing to use the internet.



Wi-Fi Connection

A LAN equipped air conditioner can easily be joined to a local Wi-Fi network. Once connected, the system can be controlled from any networked Android or iOS device.



Internet Connection

All you need is a permanent internet connection for your Wi-Fi network, and an internet connection for your phone or tablet and you can monitor and control your system from virtually anywhere.

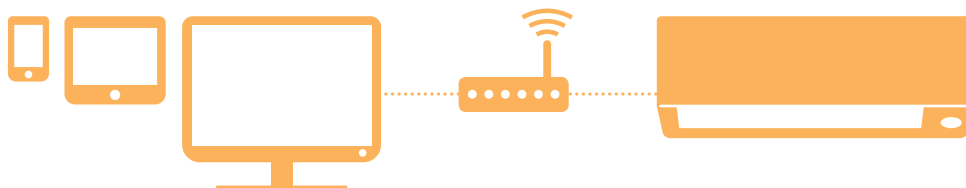

Download on the
App Store



GET IT ON
Google Play

DAIKIN MOBILE CONTROLLER
daikin.co.nz